



Mini Polipasto Palanca 500Kg Min. 24.5 cm Max 1.5 mt

Características Esenciales

- 3 Años de Garantía, Servicio y Atención al Cliente en Chile

Especificaciones Técnicas

| | | | |
|---|------------------|--------------------------|---|
| Capacidad de Carga | 1100 lb / 500 kg | Dimensiones de la Cadena | 4.3 x 12 mm |
| Altura de Izaje Estandar (Customizable) | 5 ft / 1.5 m | Caidas de Cadena | 1 |
| Fuerza de Palanca | 79 lbs / 36 kg | Normas | ANSI/ASME B30.21, EN13157, ISO 16877-2008 |
| Tipo de Cadena | G80 | Garantía | 3 Year |

| MODEL | PWYAL025 | PWYAL050 | PWYAL075 | PWYAL100 | PWYAL150 | PWYAL300 | PWYAL600 | PWYAL900 |
|-------|-----------------|-----------------|-----------------|-----------------|-----------------|-----------------|-----------------|---------------|
| A | 3.1 in / 78.5mm | 3.7 in / 95mm | 5.8 in / 148mm | | 6.8 in / 172mm | 7.9 in / 200mm | | |
| B | 2.4 in / 62mm | 2.7 in / 68mm | 3.5 in / 90mm | | 3.9 in / 98mm | 4.5 in / 115mm | | |
| C | 1.4 in / 36mm | 1.7 in / 42mm | 1.5 in / 37mm | 1.7 in / 45mm | 1.9 in / 47mm | 2.5 in / 63mm | 3.1 in / 78mm | |
| D | 5.9 in / 150mm | 8.4 in / 215mm | 11 in / 280mm | | 16.1 in / 410mm | | | |
| E | 0.8 in / 21mm | 0.9 in / 24.5mm | 1.1 in / 28mm | 1.2 in / 33mm | 1.5 in / 33.5mm | 1.7 in / 43.5mm | 2.0 in / 51mm | 2.5 in / 64mm |
| H | 8.3 in / 210mm | 10 in / 255mm | 12.7 in / 325mm | 12.7 in / 325mm | 15 in / 380mm | 19 in / 480mm | 24.5 in / 620mm | 27 in / 690mm |

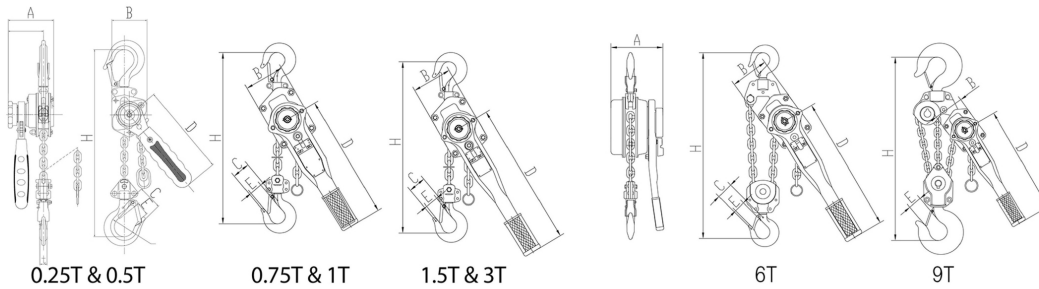

Peso & Dimensiones

Peso Total 4 lbs / 2 Kg

Detalles del Empaque

Paquete 1 Peso Neto 6 lbs / 3 Kg

Paquete 1 Ancho 4 in / 10.16 cm

Paquete 1 Peso Bruto 4 lbs / 2 Kg

Paquete 1 Altura 4 in / 10.16 cm

Paquete 1 Profundidad 11 in / 27.94 cm

Referential Images / Imágenes Referenciales
Specifications may change without notice / las especificaciones pueden cambiar sin previo aviso