

Permanent Magnetic Lifter 220 lb. / 100 kg

Características Esenciales

- 3 Años de Garantía, Servicio y Atención al Cliente en Chile

Especificaciones Técnicas

| | | | |
|--|--|-----------------|--------|
| Capacidad de Carga | 220 lb / 100 kg Max. pull off: 660 lb / 300 kg | Garantía | 3 Year |
| Rango de temperatura de Trabajo | <176°F / 80°C | | |

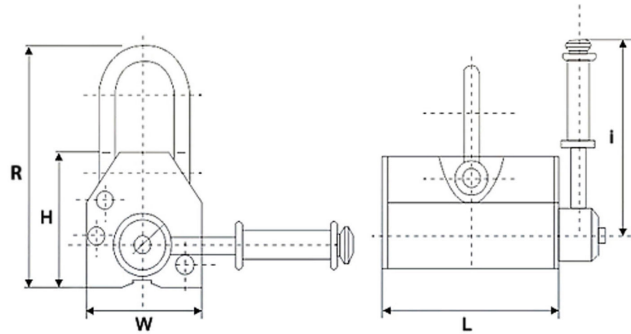

| Model/Modelo | PWML100 | PWML400 | PWML600 | PWML1000 | PWML2000 | PWML3000 | PWML4000 | PWML5000 |
|------------------------|-----------------------|---------------|---------------|----------------|----------------|----------------|----------------|----------------|
| L | 4 in / 90 mm | 6 in / 160 mm | 9 in / 220 mm | 10 in / 260 mm | 13 in / 340 mm | 17 in / 420 mm | 19 in / 480 mm | 23 in / 580 mm |
| W | 3 in / 63.5 mm | 4 in / 95 mm | 5 in / 115 mm | 6 in / 145 mm | 6 in / 160 mm | 7 in / 185 mm | 8 in / 200 mm | 12 in / 300 mm |
| H | 3 in / 68 mm | 7 in / 180 mm | 5 in / 125 mm | 6 in / 145 mm | 6 in / 165 mm | 7 in / 185 mm | 8 in / 200 mm | 12 in / 300 mm |
| R | 6 in / 145 mm | 8 in / 210 mm | 9 in / 230 mm | 11 in / 280 mm | 16 in / 410 mm | 20 in / 510 mm | | 26 in / 650 mm |
| Magnet Activation | Locking ON/OFF Handle | | | | | | | |
| Activación del magneto | Palanca ON/OFF | | | | | | | |

Peso & Dimensiones

Peso Total 8 lbs / 4 Kg

Detalles del Empaque

Paquete 1 Peso Neto 6 lbs / 3 Kg

Paquete 1 Ancho 6 in / 15.24 cm

Paquete 1 Peso Bruto 8 lbs / 4 Kg

Paquete 1 Altura 9 in / 22.86 cm

Paquete 1 Profundidad 6 in / 15.24 cm

Referential Images / Imágenes Referenciales
Specifications may change without notice / las especificaciones pueden cambiar sin previo aviso