



Cabrestante Marino Electrico de 1 Tonelada 49 ft/min

Características Esenciales

- 1 Años de Garantía, Servicio y Atención al Cliente en Chile

Copyright: The pictures contained in this site belong to Prowinch LLC and are protected by copyright under national and international law. This information may not be reproduced, adapted or modified without the written consent of Prowinch LLC. The use of these images and texts implies that you should mention Prowinch LLC as owner. By consulting this site or downloading any information you agree to these conditions.

Especificaciones Técnicas

| | | | |
|------------------------------|--|------------------------------------|---|
| Capacidad de Carga | 2200 lb / 1000 kg | Tipo de Motor | JZ2-H23-4/12 |
| Velocidad /min | 15.9 - 52.4 ft/min [4.85 - 16 m/min] | Tipo Transmisión / Reductor | Right Angle transmision CWS160-63-IV (Horizontal Motor) |
| Numero de Velocidades | 2 Speed | Relación de Transmisión | 63 : 1 |
| Voltaje | 3 Phase 440~480V 60Hz | Cable Recomendado | 48 mm |
| Potencia Total Watts | 4.3 / 1.7 kW | Garantía | 1 Year |

PWMCH1TM Models

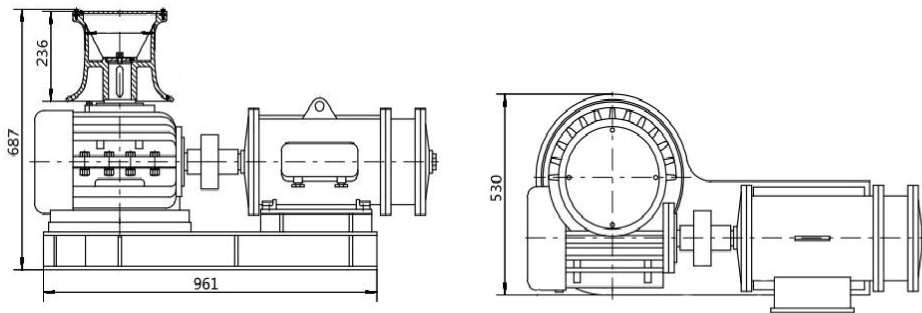

Peso & Dimensiones

BD ø Diámetro Tambor

260 mm

Referential Images / Imágenes Referenciales
Specifications may change without notice / las especificaciones pueden cambiar sin previo aviso